

GI	gran industria
GI-1	11.623
GI-2	12.409
GI-3	10.086
GI-4	10.096
GI-5	20.566
GI-6	21.298
GI-7	13.711
GI-8	10.174
GI-9	10.030
GI-11	10.892
GI-12	11.573
GI-13	11.090
GI-14	10.573
GI-15	55.619

IPMI	pequeña y mediana industria								
1	4.138	10 1.673	19 1.310	28 1.331	37 1.936	46 1.922	55 2.358	64 2.367	71c 4.822
2	1.567	11 4.553	20 1.382	29 1.331	38 1.944	47 1.922	56 2.716	65 3.885	72 1.546
3	1.567	12 4.642	21 1.328	30 2.229	39 1.948	48 1.839	57 2.191	66 2.189	73 1.732
4	1.567	13 2.987	22 1.328	31 2.144	40 3.701	49 2.229	58 2.293	67 2.212	74 1.591
5	1.705	14 2.730	23 1.328	32 1.978	41 2.180	50 2.245	59 2.287	68 2.212	75 1.684
6	7.090	15 2.712	24 2.304	33 1.899	42 2.277	51 2.252	60 2.281	69 2.212	76 1.474
7	1.817	16 1.360	25 1.357	34 1.912	43 1.922	52 2.260	61 2.275	70 2.772	77 1.474
8	1.767	17 1.318	26 1.331	35 1.920	44 1.922	53 2.266	62 2.269	71A 4.715	78 1.474
9	1.767	18 1.310	27 1.331	36 1.928	45 1.922	54 2.273	63 2.263	71B 4.866	79 1.474
									80 1.474
									81 1.395
									82 1.549
									83 1.528
									84 1.506
									85 1.484
									86 1.484
									87 1.608
									88 1.714
									89 1.714
									90 1.714
									91 1.714
									92 1.714
									93 1.714
									94 1.709
									95 1.700
									96 1.714
									97 1.714
									98 1.714
									99 1.714
									100 1.714
									101 1.714
									102 1.716
									103 2.117
									104 2.117
									105 2.117
									106 2.253
									107 2.118
									108 2.118
									109 3.117
									110 3.500
									111 1.985
									112 7.459

AUP	actividades urbanas productivas
AUP-1	4.906 m <sup>2</sup>
AUP-2	4.278 m <sup>2</sup>
AUP-3A	3.613 m <sup>2</sup>
AUP-4	6.717 m <sup>2</sup>
AUP-5A	5.789 m <sup>2</sup>

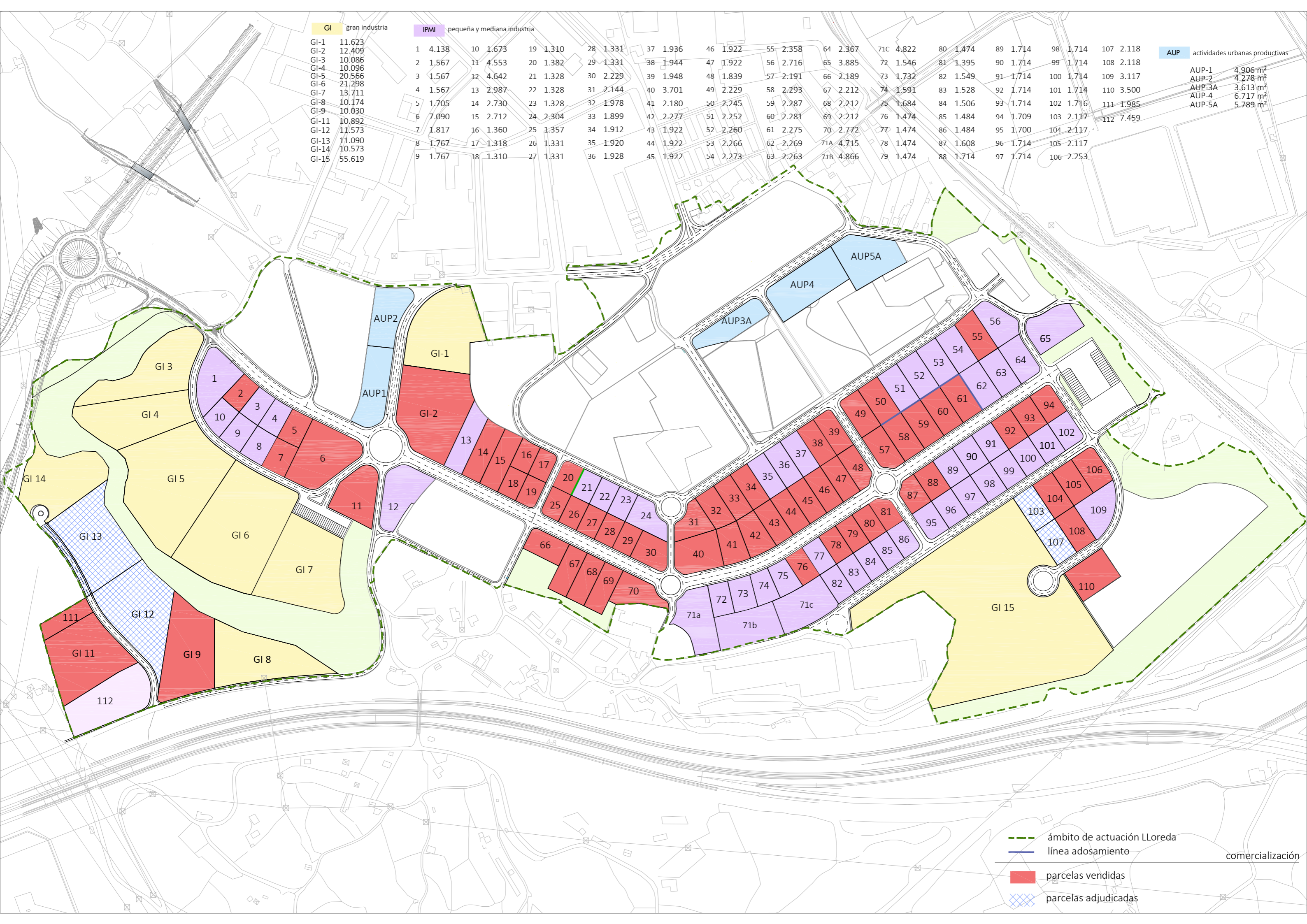

--- ámbito de actuación Llorede  
--- línea adosamiento  
■ parcelas vendidas  
■ parcelas adjudicadas

comercialización